

## ***Cat. No. 1086 Series Locks Cat. No. 1076 Series Latches***

### **MOUNTING INSTRUCTIONS**

These locks and latches are designed to be mounted through surfaces from 1/8 inch to 3/4 inches thick. The cam bars are adjustable to a maximum of 3 inches from the mounting surface. These locks and latches have a draw-down feature that by lowering the handle to the closed position, pulls the cam bar up 1/4", pulling the hatch lid tight.

- 1). Cut out the template below. Fold on dotted line. Place on mounting surface at desired location with folded tab overlapping edge.
- 2). Mark center of hole for drilling.
- 3). Drill a 2-1/2 inch hole through the mounting surface.
- 4). Use mounting gasket for smooth surfaces or discard for carpeted surfaces.
- 5). Insert lock/latch through the hole in the surface and attach spacer and back-up nut.
- 6). Re-assemble cam bar with proper adjustment. Tighten set screw and locking nut with lock washer.

***Note: For continued ease of operation, periodically apply a lock cylinder lubricant.***

### ***MOUNTING TEMPLATE***

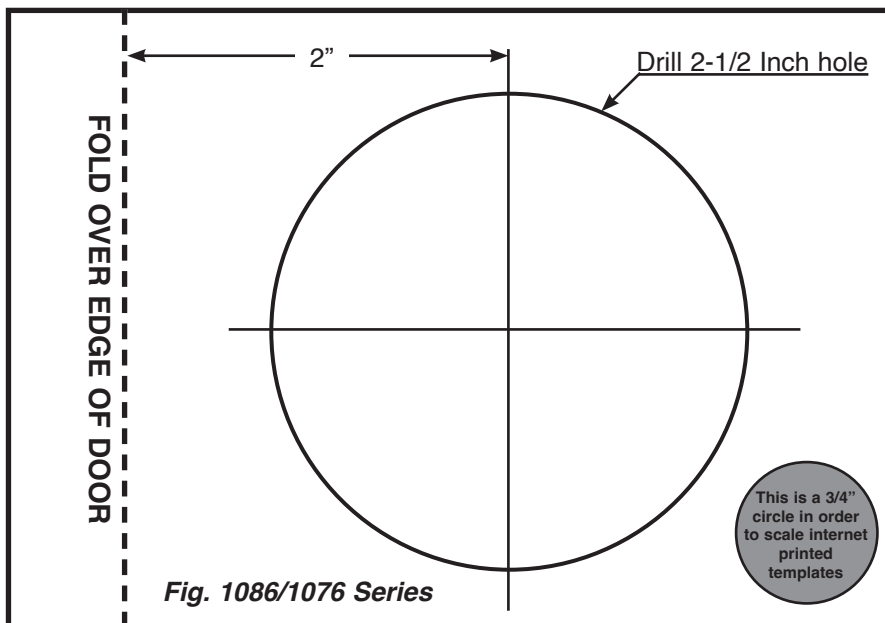

***Fig 1086  
Draw-Down Lock***

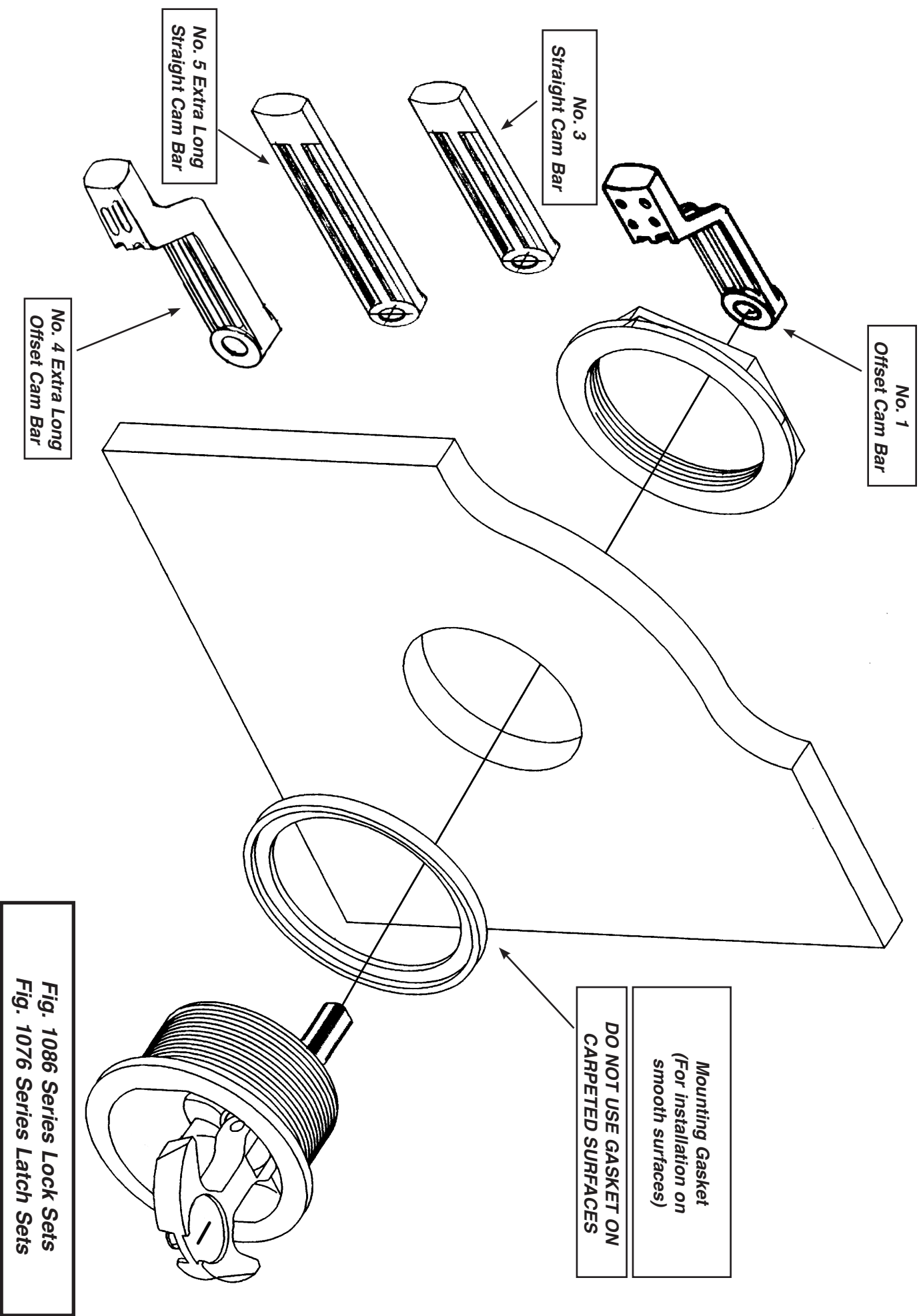

**Fig. 1086 Series Lock Sets**  
**Fig. 1076 Series Latch Sets**